

Lampholders for General-service Incandescent

Threaded casings 28x2 IEC 60399

Material: zinc-coated polished steel

Weight: 14.4/14.4/18.9/18.9 g

Unit: 500 pcs.

Type: 81022 insulating threaded ring: duroplastic, T190

Ref. No.: 103365 chrome-finish

Ref. No.: 103366 brass-finish

Type: 81017 insulating threaded ring: steatite, T240

Ref. No.: 507052 chrome-finish

Ref. No.: 507053 brass-finish

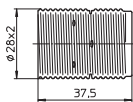

Caps

Material: zinc-coated polished steel

Female nipple: M10x1

Weight: 7.2/7.1/7.9/7.8 g

Unit: 500 pcs.

Type: 80006

Ref. No.: 102946 chrome-finish

Ref. No.: 102947 brass-finish

Type: 80003 with earth terminal

Ref. No.: 102938 chrome-finish

Ref. No.: 102939 brass-finish

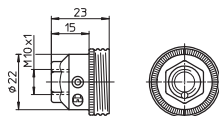
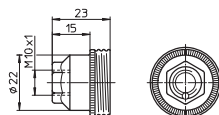

E14 Thermoplastic Rocker Switch Lampholders

For incandescent lamps with base E14

Nominal rating: 2/250

Temperature marking: T160

Suitable casings see page 293:

Type: 81093 plain casing

Type: 81109 threaded casing 28x2

Type: 81120 threaded casing 28x2, with flange

Inserts with switch

Material: PET GF

Screw terminals: 0.5–2.5 mm²

Weight: 7.9 g, unit: 1000 pcs.

Type: 83141

Ref. No.: 537087 switch, white

Ref. No.: 537088 switch, black

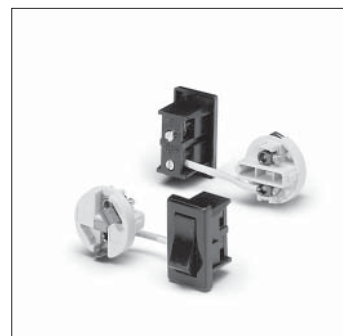
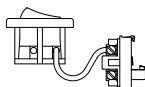

Caps

Material: PET GF

Moulded thread: M10x1

with locking screw

Weight: 9.9 g, unit: 1000 pcs.

Type: 81100

Ref. No.: 537079 white

Ref. No.: 537080 black

