

## AcciaioECO LED

**Damp and waterproof luminaire with high impact resistance and top performance:** Linear LED module with parabolic shaped aluminium reflector, specular, for high luminaire efficiency factor, narrow-wide beam. Body made of galvanized sheet steel, powder-coated, with caps made of polycarbonate / polybutylene terephthalate. Diffuser made of tempered glass, structured. Assembly for surface wall mounting, surface ceiling mounting or pendulum.

### Advantages:

- high efficiency (max. 111 lm/W)
- up to 42,4% less luminaires and 63,2% less connected load<sup>1</sup>
- easy handling through quick system
- up to 4 times faster mounted and installed
- extremely resistant against mechanical and chemical stress
- optional through wiring
- optional emergency lighting cap
- optional version with SicuroLED inverter as combined general lighting and emergency luminaire
- exchangeable LED module and LED control gear

<sup>1</sup> In comparison to standard luminaires with T5 lamp 80W



### Technical data

Mounting: surface wall or ceiling mounting, chain / wire suspension

Body: sheet steel, galvanized, powder-coated, grey (RAL 7040)

Caps: polycarbonate / polybutylene terephthalate, grey (RAL 7040)

Diffuser: tempered glass, structured

Reflector: aluminium, specular

Control gear: electronic ( $\cos \phi \geq 0,9$ )

Mains supply: 198 V - 254 V / 50 Hz

Degradation: L80 / mortality: B20

Lifetime: > 60000 h

Ambient temperature: -20 to +40 °C

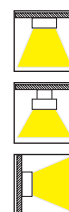
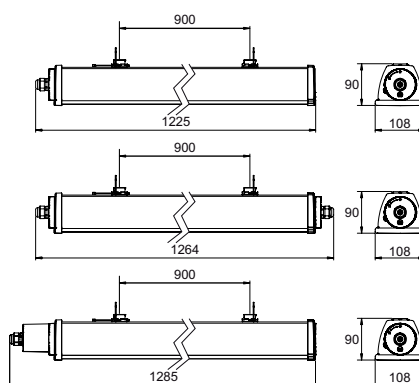

### Accessories to be ordered separately

Emergency lighting cap to upgrade a self-contained emergency luminaire with power LED, special lens and integrated automatic test device Autotest, Logica or Logica FM through exchange of one of the caps of the luminaire.



### Order code

### Description

<b>20082</b>	Emergency lighting cap LED 1 W (180 lm), NMO, 1 h, NiMH battery 7,2 V / 0,6 Ah, Autotest
<b>20086</b>	Emergency lighting cap LED 1 W (180 lm), NMO, 1 h, NiMH battery 7,2 V / 0,6 Ah, Logica-FM

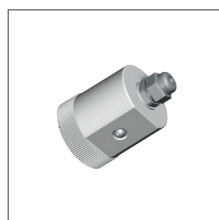

### Lighting data

### Light distribution diagram

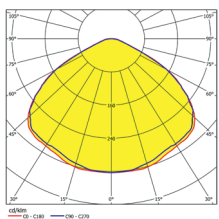

### Order code

### Mounting height (m)

Spacing (m)  
for escape route lighting (1.0 lx) and anti-panic area lighting (0.5 lx)

			1.0 lx	0.5 lx	1.0 lx	0.5 lx	1.0 lx	0.5 lx	1.0 lx	0.5 lx
<b>20082</b>	2.5		3.4	3.6	8.5	8.4	8.5	8.4	3.4	3.6
<b>20086</b>	3.0		3.6	3.8	9.2	9.4	9.2	9.4	3.6	3.8
	3.5		3.8	4.1	9.8	10.2	9.8	10.2	3.8	4.1
	4.0		3.7	4.3	10.2	10.8	10.2	10.8	3.7	4.3
	4.5		3.6	4.5	10.5	11.4	10.5	11.4	3.6	4.5
	5.0		3.3	4.5	10.7	11.8	10.6	11.8	3.3	4.5
	6.0		2.5	4.4	10.6	12.5	10.5	12.5	2.4	4.4
	7.0		-	4.2	-	12.9	-	12.9	-	4.2
	7.5		-	3.8	-	13.0	-	13.0	-	3.8

## Light distribution diagram

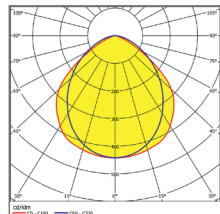
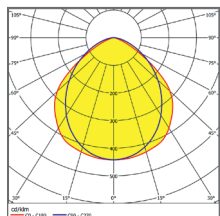

## Order code    Type

## Lamp

Luminous  
flux

## Light color

Color  
renderingPower  
consumption

## Weight

## PU

## Versions without through wiring

<b>A136E</b>	Acciaio E LED 1 x 36 W D 4 K	LED 17 W	2100 lm	4000 K	>80	19 W	3.2 kg	1
<b>A236E</b>	Acciaio E LED 2 x 36 W D 4 K	LED 32 W	4000 lm	4000 K	>80	36 W	3.2 kg	1
<b>A158E</b>	Acciaio E LED 1 x 58 W D 4 K	LED 25 W	3100 lm	4000 K	>80	28 W	3.2 kg	1
<b>A258E</b>	Acciaio E LED 2 x 58 W D 4 K	LED 52 W	6000 lm	4000 K	>80	55 W	3.2 kg	1

## Versions with through wiring 5 x 1.5 mm

<b>A136EP</b>	Acciaio E LED P 1 x 36 W D 4 K	LED 17 W	2100 lm	4000 K	>80	19 W	3.5 kg	1
<b>A236EP</b>	Acciaio E LED P 2 x 36 W D 4 K	LED 32 W	4000 lm	4000 K	>80	36 W	3.5 kg	1
<b>A158EP</b>	Acciaio E LED P 1 x 58 W D 4 K	LED 25 W	3100 lm	4000 K	>80	28 W	3.5 kg	1
<b>A258EP</b>	Acciaio E LED P 2 x 58 W D 4 K	LED 52 W	6000 lm	4000 K	>80	55 W	3.5 kg	1



Version with automatic dimming Logica AutoDimm with integrated light sensor and daylight dependent control of the light flux for implementation of a constant level of lighting as well as optional with centralised monitoring and control through Logica FM Control.

## Versions without through wiring

<b>AD136E</b>	Acciaio E DIM 1 x 36 D 4 K	LED 17 W	2100 lm	4000 K	>80	19 W	3.2 kg	1
<b>AD236E</b>	Acciaio E DIM 2 x 36 D 4 K	LED 32 W	4000 lm	4000 K	>80	36 W	3.2 kg	1
<b>AD158E</b>	Acciaio E LED DIM 1 x 58 D 4 K	LED 25 W	3100 lm	4000 K	>80	28 W	3.2 kg	1
<b>AD258E</b>	Acciaio E LED DIM 2 x 58 D 4 K	LED 52 W	6000 lm	4000 K	>80	55 W	3.2 kg	1

## Versions with through wiring 5 x 1.5 mm

<b>AD136EP</b>	Acciaio E LED DIM P 1 x 36W D 4K	LED 17 W	2100 lm	4000 K	>80	19 W	3.5 kg	1
<b>AD236EP</b>	Acciaio E LED DIM P 2 x 36W D 4K	LED 32 W	4000 lm	4000 K	>80	36 W	3.5 kg	1
<b>AD158EP</b>	Acciaio E LED DIM P 1 x 58W D 4K	LED 25 W	3100 lm	4000 K	>80	28 W	3.5 kg	1
<b>AD258EP</b>	Acciaio E LED DIM P 2 x 58W D 4K	LED 52 W	6000 lm	4000 K	>80	55 W	3.5 kg	1



With integrated SicuroLED inverter for operation on the decentralised supply system SicuroLED.

## Order code

## Type

## Lamp

Luminous  
flux

## Light color

Color  
renderingPower  
consumption

## Weight

## PU

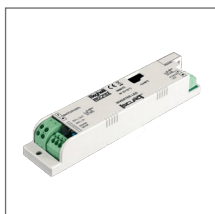

<b>A136E-S24</b>	Acciaio E LED 1 x 36 W D 4 K	LED 17 W	2100 lm	4000 K	>80	19 W	3.2 kg	1
<b>A236E-S24</b>	Acciaio E LED 2 x 36 W D 4 K	LED 32 W	4000 lm	4000 K	>80	36 W	3.2 kg	1
<b>A158E-S24</b>	Acciaio E LED 1 x 58 W D 4 K	LED 25 W	3100 lm	4000 K	>80	28 W	3.2 kg	1
<b>A258E-S24</b>	Acciaio E LED 2 x 58 W D 4 K	LED 52 W	6000 lm	4000 K	>80	55 W	3.2 kg	1