

Tubular terminals, standard series

HUPtype

- For stranded round shaped conductors e.g. VDE 0295 class 2
- For preround sector shaped conductors • Annealed material for easier crimping
- Material: 99.9% electrolytic copper E-CU DIN 40500 • Surface: tin-plated
- Vibration and shock proofing DIN EN 61373:1999-11, Cat. 1, Cl. B



Cu

available with and without sight hole e.g. 29 00 04/S (add xx xx xx/s when ordering)

Art. no.	CSS	M	d2	d1	d4	A	v1	v2	l	B	c1	c2	kg/100	PU	PU
290004	120	8	8,5	15,0	19,5	26,0	2	1	51,0	28,0	14,0	14,0	6,300	60	15
290006 *		10	10,5	15,0	19,5	26,0	2	1	51,0	28,0	14,0	14,0	6,200	60	15
290008 *		12	13,0	15,0	19,5	26,0	2	1	51,0	28,0	14,0	14,0	6,100	60	15
290009		14	15,0	15,0	19,5	26,0	2	1	52,0	28,0	15,0	15,0	5,900	72	18
290010		16	17,0	15,0	19,5	26,0	2	1	54,0	30,0	16,0	16,0	6,200	60	15
290012		20	21,0	15,0	19,5	26,0	2	1	63,0	36,0	22,0	22,0	7,900	60	15
290014	150	10	10,5	16,5	21,0	30,0	2	1	56,0	31,0	14,0	14,0	7,500	60	15
290016 *		12	13,0	16,5	21,0	30,0	2	1	57,0	31,0	15,0	15,0	7,300	60	15
290017		14	15,0	16,5	21,0	30,0	2	1	57,0	31,0	15,0	15,0	7,900	60	15
290018		16	17,0	16,5	21,0	30,0	2	1	58,0	31,0	16,0	16,0	7,500	60	15
290020		20	21,0	16,5	21,0	30,0	2	1	66,0	36,0	22,0	22,0	8,800	48	12
290022 *	185	12	13,0	19,0	24,0	30,0	2	1	65,0	35,0	18,0	18,0	11,100	40	20
290023		14	15,0	19,0	24,0	30,0	2	1	65,0	35,0	18,0	18,0	11,800	40	20
290024 *		16	17,0	19,0	24,0	30,0	2	1	65,0	35,0	18,0	18,0	10,700	40	20
290026		20	21,0	19,0	24,0	30,0	2	1	69,0	39,0	22,0	22,0	10,700	40	20
290028 *	240	12	13,0	21,0	26,0	35,0	4	2	72,0	39,0	21,5	19,0	13,700	30	15
290029		14	15,0	21,0	26,0	35,0	4	2	72,0	39,0	21,5	19,0	13,400	30	15
290030 *		16	17,0	21,0	26,0	35,0	4	2	72,0	39,0	21,5	19,0	13,400	30	15
290034	300	12	13,0	23,5	29,5	44,0	4	2	87,0	43,0	24,0	24,0	22,000	16	8
290036		14	15,0	23,5	29,5	44,0	4	2	87,0	43,0	24,0	24,0	21,700	16	8
290038		16	17,0	23,5	29,5	44,0	4	2	87,0	43,0	24,0	24,0	21,300	16	8
290040		20	21,0	23,5	29,5	44,0	4	2	87,0	43,0	24,0	24,0	21,400	16	8
290046	400	16	17,0	27,0	34,0	44,0	4	2	90,0	49,0	24,0	24,0	31,800	10	5
290048		20	21,0	27,0	34,0	44,0	4	2	90,0	49,0	24,0	24,0	30,500	10	5
290041	500	16	17,0	31,0	38,0	70,0	4	2	103,0	55,0	24,0	24,0	45,000	12	6
290043		20	21,0	31,0	38,0	70,0	4	2	103,0	55,0	24,0	24,0	45,000	12	6
290045	625	16	17,0	34,0	41,0	70,0	4	2	108,0	60,0	24,0	24,0	49,200	6	3
290047		20	21,0	34,0	41,0	70,0	4	2	108,0	60,0	24,0	24,0	49,200	6	3

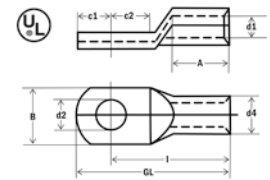

Brunel
access to excellence

Angled tubular cable lugs 90°, standard series

HUPtype

- For stranded round shaped conductors e.g. VDE 0295 class 2
- For preround sector shaped conductors • Annealed material for easier crimping
- Material: 99.9% electrolytic copper E-CU DIN 40500
- Surface: tin-plated



Cu

Art. no.	CSS	M	d2	d1	d4	A	v1	v2	l	B	c1	c2	kg/100	PU	PU
290932/90	6	5	5,3	3,5	6,5	9,0	1	-	21,0	10,0	6,5	7,5	0,475	1800	100
290934/90		6	6,5	3,5	6,5	9,0	1	-	21,0	12,0	6,5	7,5	0,400	1400	100
290936/90		8	8,5	3,5	6,5	9,0	1	-	23,0	15,0	10,0	10,0	0,500	1400	100
290938/90	10	5	5,3	4,5	7,0	10,0	1	-	22,0	12,0	6,5	7,5	0,400	1000	100
290940/90		6	6,5	4,5	7,0	10,0	1	-	22,0	12,0	6,5	7,5	0,400	1000	100
290942/90		8	8,5	4,5	7,0	10,0	1	-	25,0	15,0	10,0	10,0	0,540	800	100
290944/90		10	10,5	4,5	7,0	10,0	1	-	27,0	17,0	12,0	12,0	0,573	600	100
290948/90	16	5	5,3	5,5	8,5	13,0	1	1	26,0	12,0	5,5	6,5	0,800	600	100
290950/90		6	6,5	5,5	8,5	13,0	1	1	27,0	12,0	6,25	7,5	0,700	600	100
290952/90		8	8,5	5,5	8,5	13,0	1	1	29,0	15,0	8,5	9,5	0,800	400	100
290954/90		10	10,5	5,5	8,5	13,0	1	1	31,0	17,0	10,5	11,5	0,950	400	100
290956/90		12	13,0	5,5	8,5	13,0	1	1	33,0	19,0	12,0	13,0	1,000	400	100
290958/90	25	6	6,5	7,0	10,0	15,0	2	1	30,0	14,0	7,5	7,5	1,100	400	50
290960/90		8	8,5	7,0	10,0	15,0	2	1	32,0	16,0	10,0	10,0	1,200	400	50
290962/90		10	10,5	7,0	10,0	15,0	2	1	34,0	18,0	12,0	12,0	1,250	300	50
290964/90		12	13,0	7,0	10,0	15,0	2	1	35,0	19,0	13,0	13,0	1,300	300	50

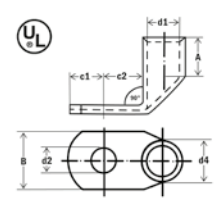

Angled tubular cable lugs 90°, standard series

HUPtype

- For stranded round shaped conductors e.g. VDE 0295 class 2
- For preround sector shaped conductors • Annealed material for easier crimping
- Material: 99.9% electrolytic copper E-CU DIN 40500
- Surface: tin-plated



Cu

Art. no.	CSS	M	d2	d1	d4	A	v1	v2	l	B	c1	c2	kg/100	PU	
290966/90	35	6	6,5	8,5	12,0	17,0	2	1	32,0	17,0	7,5	7,5	1,900	240	40
290968/90		8	8,5	8,5	12,0	17,0	2	1	34,0	17,0	10,0	10,0	1,900	240	40
290970/90		10	10,5	8,5	12,0	17,0	2	1	37,0	19,0	12,0	12,0	2,100	160	40
290972/90		12	13,0	8,5	12,0	17,0	2	1	38,0	21,0	13,0	13,0	2,000	160	40
290976/90	50	6	6,5	10,0	14,0	19,0	2	1	37,0	20,0	10,0	10,0	2,900	160	40
290978/90		8	8,5	10,0	14,0	19,0	2	1	37,0	20,0	10,0	10,0	2,700	160	40
290980/90		10	10,5	10,0	14,0	19,0	2	1	39,0	20,0	12,0	12,0	2,900	150	25
290982/90		12	13,0	10,0	14,0	19,0	2	1	43,0	23,0	13,0	13,0	3,300	100	25
290986/90	70	8	8,5	12,0	16,5	21,0	2	1	43,0	23,0	10,0	10,0	4,200	100	25
290988/90	*	10	10,5	12,0	16,5	21,0	2	1	44,0	23,0	12,0	12,0	4,300	100	25
290990/90		12	13,0	12,0	16,5	21,0	2	1	46,0	23,0	13,0	13,0	4,500	100	25
290992/90		16	17,0	12,0	16,5	21,0	2	1	50,0	28,0	16,0	16,0	5,100	100	25
290994/90	95	8	8,5	13,5	18,0	25,0	2	1	48,0	26,0	12,0	12,0	5,300	100	25
290996/90		10	10,5	13,5	18,0	25,0	2	1	48,0	26,0	12,0	12,0	5,100	100	25
290998/90		12	13,0	13,5	18,0	25,0	2	1	49,0	26,0	13,0	13,0	5,200	100	25
291000/90		16	17,0	13,5	18,0	25,0	2	1	54,0	28,0	16,0	16,0	5,600	60	15
291002/90		20	21,0	13,5	18,0	25,0	2	1	60,0	36,0	22,0	22,0	6,000	60	15
290006/90	120	10	10,5	15,0	19,5	26,0	2	1	51,0	28,0	14,0	14,0	6,200	60	15
290008/90		12	13,0	15,0	19,5	26,0	2	1	51,0	28,0	14,0	14,0	6,100	60	15
290010/90		16	17,0	15,0	19,5	26,0	2	1	54,0	30,0	16,0	16,0	6,200	60	15
290014/90	150	10	10,5	16,5	21,0	30,0	2	1	56,0	31,0	14,0	14,0	7,500	60	15
290016/90		12	13,0	16,5	21,0	30,0	2	1	57,0	31,0	15,0	15,0	7,300	60	15
290018/90		16	17,0	16,5	21,0	30,0	2	1	58,0	31,0	16,0	16,0	7,500	60	15
290020/90		20	21,0	16,5	21,0	30,0	2	1	66,0	36,0	22,0	22,0	8,800	60	12
291004/90	185	10	10,5	19,0	24,0	30,0	2	1	65,0	35,0	18,0	18,0	11,100	40	20
290022/90		12	13,0	19,0	24,0	30,0	2	1	65,0	35,0	18,0	18,0	11,100	40	20
290024/90		16	17,0	19,0	24,0	30,0	2	1	65,0	35,0	18,0	18,0	10,700	40	20
290028/90	240	12	13,0	21,0	26,0	35,0	4	2	72,0	39,0	21,5	19,0	13,700	30	15
290030/90		16	17,0	21,0	26,0	35,0	4	2	72,0	39,0	21,5	19,0	13,400	30	15

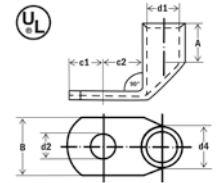

Butt connectors, standard series

HUPtype

- Material: 99.9% E-CU DIN 40500
- Surface: tin-plated • Annealed material for easier crimping
- For stranded conductors e.g. VDE 0295 class 2
- with buttmarks for precise cable insertion



Cu

Art. no.	CSS	d1	d4	v1	v2	TL	kg/100	PU	
291050	0,75	1,3	2,8	1	-	14	0,051	2000	100
291052	1,5	1,8	3,3	1	-	14	0,074	2000	100
291054	2,5	2,3	4,2	1	-	16	0,150	2000	100
291056	4	3,0	5,0	1	-	19	0,195	1000	100
291058	6	3,5	6,5	1	-	19	0,350	1000	100
291060	10	4,5	7,0	1	-	30	0,558	600	100
291062	16	5,5	8,5	1	1	35	0,984	500	50
291064	25	7,0	10,0	2	1	40	1,350	200	50
291066	35	8,5	12,0	2	1	45	2,150	200	50
291068	50	10,0	14,0	2	1	50	3,100	100	25
291070	70	12,0	16,5	2	1	55	4,700	50	25
291072	95	13,5	18,0	2	1	60	5,600	50	25
291074	120	15,0	19,5	2	1	65	6,800	60	15
291076	150	16,5	21,0	2	1	70	7,800	40	20
291078	185	19,0	24,0	2	1	80	11,700	30	5
291080	240	21,0	26,0	4	2	90	13,900	20	10
291082	300	23,5	29,5	4	2	100	22,300	10	5
291084	400	27,0	34,0	4	2	100	29,000	10	5

