

Technical Data Sheet

CODE 15195

TORRETTA TRT 180 E-V 6P

Centrifugal roof fans with vertical discharge



CE



TECHNICAL AND PERFORMANCE DATA

Absorbed Current max (A)	5,95	Number of Poles	6
Absorbed Power max (W)	3100	Voltage (V)	400
Frequency (Hz)	50	Weight (Kg)	176
Insulation Class	I°	Delivery max (l/s)	4444
Max ambient temperature for continuous operation (°C)	80	Delivery max (m³/h)	16000
Motor IP protection	55	Pressure max (mmH2O)	79
Nominal Diameter (mm)	550	Pressure max (Pa)	775
Number of Phases (Ph)	3	RPM	970
		Sound Pressure level Lp [dB (A)] 3m	83

DIMENSIONS

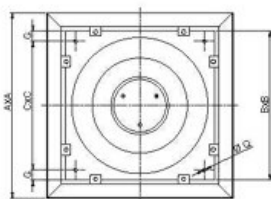
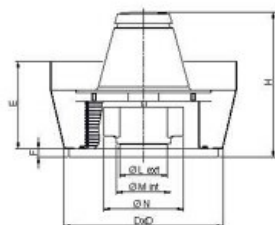

Size A (mm)	1462
Size B (mm)	980
Size C (mm)	900
Size D (mm)	1010
Size E (mm)	595
Size F (mm)	38
Size G (mm)	40
Size H (mm)	903
Size L (mm)	520

PER INFORMAZIONI:

Servizio al Cliente: tel +39 02 90699395 premendo 1 dopo messaggio registrato (consulenza su prodotti e impianti)

Pre & Post Vendita: fax +39 02 90699302

Email prevendita: prevendita@vortice-italy.com

Technical Data Sheet

CODE 15195

TORRETTA TRT 180 E-V 6P

Centrifugal roof fans with vertical discharge



DESCRIPTION

- Base manufactured from phosphated pressed steel, epoxy powder
- Aerodynamically contoured inlet port for optimum performance, fashioned as a single unit with the base and gauged to optimize air
- Pressed steel motor cover: pickled and phosphated surface, polyester
- Zinc-coated, pickled and phosphated surface, polyester powder coated
- Accident prevention and anti-bird grilles (to UNI ISO 13857 standard), consisting of electrically welded steel rings with epoxy powder coated

- Centrifugal impeller with self-cleaning backward curved steel blades, hot-dip galvanized and dynamically balanced (UNI ISO 1940, Point 1 - Class 6.3), and splined steel hub.
- Cooling fan for better dissipation of heat
- Galvanized steel eye lugs for transport and lifting/handling operations.
- Cable guaranteeing continuity of earth connection.
- Steel safety wire for anchoring appliances once installed.
- Vortice speed controller.

ACCESSORIES

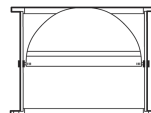
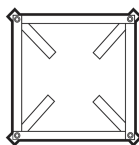
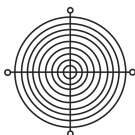

TR-G

100/150/180/210

6-8P(GRIGLI

APROT.)

Code 22507

TR-B

100/150/180/210

6-8P (BOCC.

ASPIR.)

Code 22509

TR-CU

100/150/180/210

6-

8P(CONTROT.BASE)8P(SERRANDA

Code 22540

TR-S

100/150/180/21

6-

8P(SERRANDA

GRA)

Code 22542



PER INFORMAZIONI:

Servizio al Cliente: tel +39 02 90699395 premando 1 dopo messaggio registrato (consulenza su prodotti e impianti)

Pre & Post Vendita: fax +39 02 90699302

Email prevendita: prevendita@vortice-italy.com