

# Technical Data Sheet

CODE 16121

## CA 125 MD E W

Centrifugal duct fans for wall mounting



### Certifications



IMQ



CE



IMQ Performance



EAC



G-Mark

### TECHNICAL AND PERFORMANCE DATA

Absorbed power 1st speed (W)	25	Delivery 1st speed (l/s)	44.4
Frequency (Hz)	50/60	Delivery 1st speed (m <sup>3</sup> /h)	160
Insulation Class	II°	Max delivery at max speed (l/s)	123.6
IP	44	Max delivery at max speed (m <sup>3</sup> /h)	445
Max absorbed Power at 60Hz (W)	100	Pressure - 1st speed (mmH2O)	13.9
Max ambient temperature for continuous operation (°C)	50	Pressure - 1st speed (Pa)	136.5
Max. absorbed Current at max. speed (A)	0,23	Pressure max - max speed (mmH2O)	36.2
Max. absorbed Current at min. speed (A)	0.13	Pressure max - max speed (Pa)	355.9
Max. absorbed power at max speed (W)	85	RPM max	2445
Nominal Diameter (mm)	125	RPM min	935
Voltage (V)	220-240	Sound pressure level Lp [dB (A)] 3m - max speed	39.4
Weight (Kg)	3,8	Sound pressure level Lp [dB (A)] 3m - min speed	25.5

### DIMENSIONS

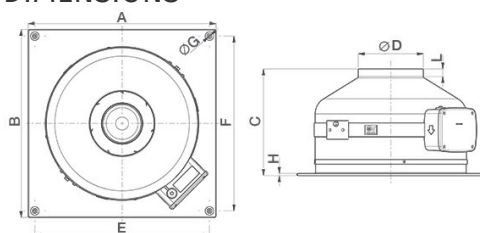

Size A (mm)	334
Size B (mm)	334
Size C (mm)	210
Size D (mm)	∅ 122
Size E (mm)	304
Size F (mm)	304
Size G (mm)	∅ 5
Size H (mm)	5
Size L (mm)	23
Size M (mm)	198

#### PER INFORMAZIONI:

Servizio al Cliente: tel +39 02 90699395 premendo 1 dopo messaggio registrato (consulenza su prodotti e impianti)

Pre & Post Vendita: fax +39 02 90699302

Email prevendita: [prevendita@vortice-italy.com](mailto:prevendita@vortice-italy.com)

# Technical Data Sheet

CODE 16121

## CA 125 MD E W

Centrifugal duct fans for wall mounting



### DESCRIPTION

- Pickled and phosphated steel housing/roof mounting plate with polyester powder-coated finish, resistant to the aggressive action of atmospheric agents.
- Nominal diameter 125 mm.
- 3 speed fan through TRIO-CA optional control (cod. 12869), consisting of:
  - AC motor with thermal overload cutout and shaft turning in ball bearings,
  - backward curved impeller.
- Operation controllable by remote sensors monitoring: Temperature, Relative Humidity, Smoke and Presence.
- Zinc-coated steel brackets for wall mounting.

### CURVES

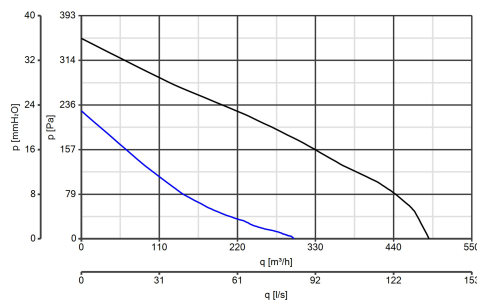
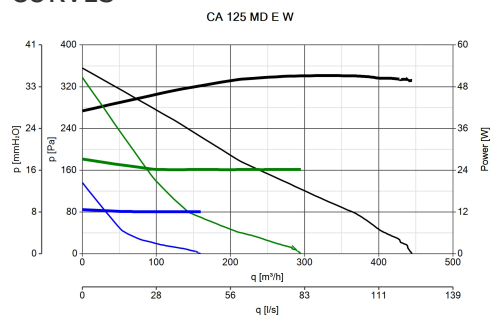

### ACCESSORIES



TRIO-CA  
Code 12869



KIT SCB  
(TRASF.E.C.)  
Code 22481



CA-G 125  
(GRIGLIA DI  
PROTEZIONE)  
Code 22755



C 1.5  
(COMANDO EL.  
1.5 A)  
Code 12966

#### PER INFORMAZIONI:

Servizio al Cliente: tel +39 02 90699395 premendo 1 dopo messaggio registrato (consulenza su prodotti e impianti)  
Pre & Post Vendita: fax +39 02 90699302  
Email prevendita: [prevendita@vortice-italy.com](mailto:prevendita@vortice-italy.com)