

Technical Data Sheet

CODE 42228

MPC-E 404 M

Medium-pressure long cased axial fans



Certifications



TECHNICAL AND PERFORMANCE DATA

Absorbed Current max (A)	1,30	Number of Poles	4
Absorbed Power max (W)	272	Voltage (V)	230
Frequency (Hz)	50	Weight (Kg)	14,0
Insulation Class	I°	Delivery max (l/s)	1333
IP	X4	Delivery max (m³/h)	4800
Max ambient temperature for continuous operation (°C)	70	Pressure max (mmH2O)	18.7
Min ambient temperature for continuous operation (°C)	-25	Pressure max (Pa)	183
Nominal Diameter (mm)	400	RPM	1440
Number of Phases (Ph)	1	Sound power level Lw [dB(A)]	68.6
		Sound Pressure level Lp [dB (A)] 3m	48.1

DIMENSIONS

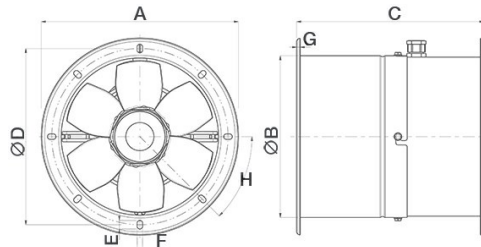

Size A (mm)	ø 475
Size B (mm)	ø 418
Size C (mm)	330
Size D (mm)	ø 448
Size E (mm)	14
Size F (mm)	9
Size G (mm)	4
Size H (mm)	45°

PER INFORMAZIONI:

Servizio al Cliente: tel +39 02 90699395 premendo 1 dopo messaggio registrato (consulenza su prodotti e impianti)

Pre & Post Vendita: fax +39 02 90699302

Email prevendita: prevendita@vortice-italy.com

Technical Data Sheet

CODE 42228

MPC-E 404 M

Medium-pressure long cased axial fans



DESCRIPTION

- Nominal diameter 400 mm
- 2 rolled steel flange sections, welded, phosphated and polyester powder coated in practical grey colour with hammered effect finish, guaranteeing long-term resistance to atmospheric agents.
- 1 speed single phase AC motor with shaft turning in double shielded ball bearings, insulation class F.
- Maximum air flow: 5.000 m³/h.
- Impeller with 6 wing profile blades, dynamically balanced (UNI ISO 1940 – Balancing class 6.3), optimized to deliver maximum performance and low noise levels, moulded from filled polypropylene for superior dimensional stability and resistance to atmospheric agents, and keyed to a diecast aluminium hub.
- Vortice speed controller.

CURVES

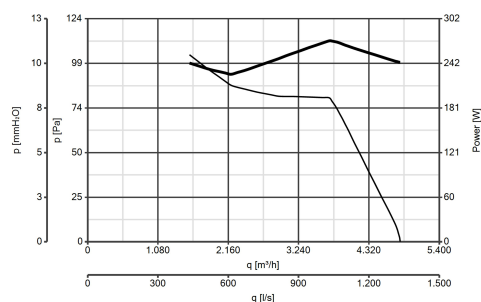

ACCESSORIES



IREM 3 CD
99250080
Code 12931

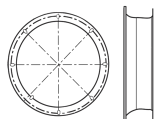

MPC BO 400
(BOCCAGLIO)
Code 22538

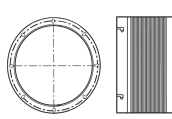

MPC RA 400
(RACCORDO
FLESSIBILE)
Code 22519



MPC SU 400
(SUPPORTO)
Code 22534

PER INFORMAZIONI:

Servizio al Cliente: tel +39 02 90699395 premendo 1 dopo messaggio registrato (consulenza su prodotti e impianti)
Pre & Post Vendita: fax +39 02 90699302
Email prevendita: prevendita@vortice-italy.com