

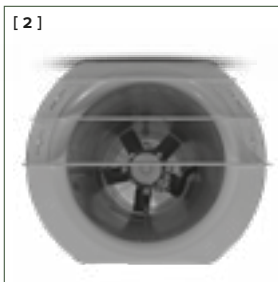

Efectis

Certification of conformity to EN 12101-3
standard issued by EPECTIS

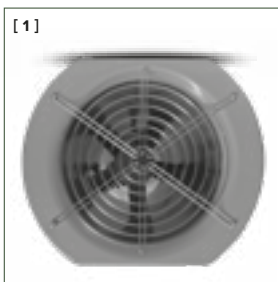

VORT JET A RANGE

Impulse axial jet fans



Axial impulse jet fans specifically designed for installation in underground car parks, guaranteeing the correct removal of exhaust gases and the effective and prompt extraction of high temperature fumes and the simultaneous creation of suitable escape routes for occupants in the event of fire.

There are many benefits of installing this type of appliance, which can be summarised as:

- High efficacy: the area of fire and smoke propagation is limited in view of its rapid removal.
- Easy and economic installation, in virtue of the absence of piping and ducts.
- Reduced consumption, up to 40% lower with respect to traditional ventilation systems, thanks to no pressure drops that can be traced to the piping.
- Lower electrical plant costs, given the possibility of using smaller and less expensive emergency generators.
- Easy maintenance.
- Flexible installation, thanks to proportionally reduced clearance.
- Maximised use of car park volumes, given the absence of cumbersome ducts.

Key features

- Thanks to the double speed motors, it is possible to combine ventilation mode operation, to guarantee suitable ventilation in car parks, to Fire Safety mode, with the action of the appropriately positioned MPC ED and MPC HP fans, appropriately positioned in the car park for the extraction of fumes and the simultaneous contribution of non-polluted air in correspondence with escape routes.
- Possibility of guaranteeing car park safety in the event of fire by minimising the number of units installed, thanks to the possibility of inverting the direction of the flow induced (Reversible R versions).
- Possibility of installation even in car parks with low ceilings, frequently found in cities, thanks to the availability of reduced diameter models.
- Completeness of the solution proposed, which is not limited simply to fans, but which also includes an extensive catalogue of accessories (alarm control units, sensors, shutters, etc.) accompanying the system, with the added value of support system design service, offered as an optional.

Versions

- 8 models, different based on the dimensions, functions and performance offered.



Technical features

- Galvanised sheet steel construction.
- Mono or bi-directional axial fans (R models), made of impellers with nominal diameters of 315, 355 and 400 mm, with die-cast aluminium airfoil blades, designed to optimise aeraulic efficiency, reduce the formation of vortices and thus contain consumption and noise emissions. Double speed, three-phase induction motors, with shafts turning on ball bearings (Dahlander system).
- Galvanised sheet steel deflectors mounted on the extraction side on unidirectional models. The deflectors are present at both ends on the reversible models (R).
- Galvanised steel grille on the delivery side.
- Galvanised steel sheet brackets for ceiling installation, supplied as standard with the product.
- Galvanised steel sheet oval end silencers, to contain clearance. Designed to guarantee correct laminar flow of the air handled. Rock wool sound-proofing lining with density 80 kg/m3.
- Electrical junction box mounted outside the product, for easy access to correctly wire the product to the mains.

TECHNICAL DATA

PRODUCTS	CODE	DIAM. Ø (M)	V~50HZ	MOTOR POWER (KW)	A	POLES	FLOW RATE M³/H MIN/MAX	AIR SPEED (M/S)	LP DB(A) MIN/MAX @ 1 M	CLASS.	THRUST (N)	KG
VORT JET-A 315/2	45641	315	400	0.24	0.72	2/4	2250	16	48 66	F300-120	6	114
VORT JET-A 315/2 R*	45643			0.96	2.3		4500	8	49 67		24	115.2
VORT JET-A 355/2	45645	355	400	0.3	0.96	2/4	3500	20	53 70	F300-120	10	123.4
VORT JET-A 355/2 R*	45647			1.32	2.99		7000	10	54 71		45	124.6
VORT JET-A 400/2	45649	400	400	0.3	0.96	2/4	4100	18.2	50 63	F300-120	13	139.3
VORT JET-A 400/2 R*	45651			1.32	2.99		8200	9.3	52 64		50	140.5
VORT JET-A 400/2 S	45653	400	400	0.6	1.85	2/4	5000	11.8	54 70	F300-120	21	148.3
VORT JET-A 400/2 S R*	45655			2.64	5.56		10000	23.7	55 72		85	149.5
							5325	11.2			19	
							10650	22.3			75	

*Reversible models





INDUSTRIAL VENTILATION

VORT JET A RANGE

DIMENSIONS

VORT JET-A RANGE

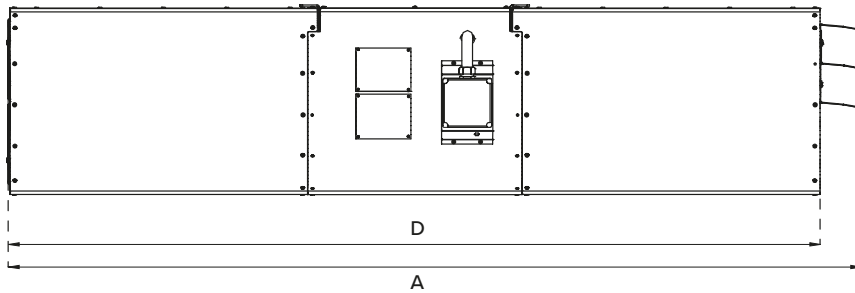

VORT JET-A R RANGE

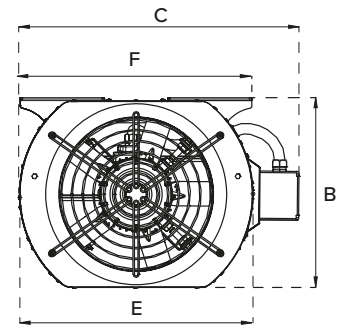
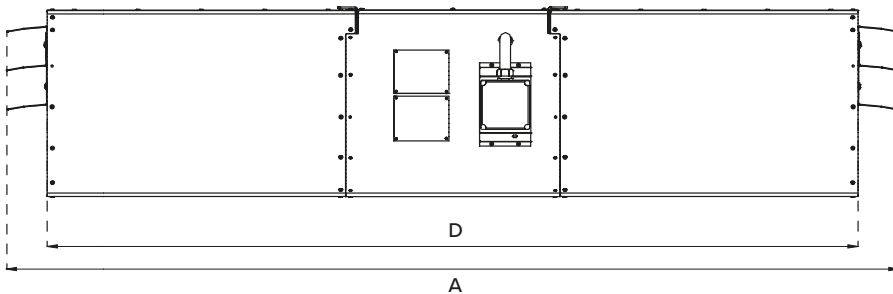



PRODUCTS	A	B	C	D	E	F
VORT JET-A 315	1747	389	572	1661	478	475
VORT JET-A 355	1907	444	613	1821	514	515
VORT JET-A 400	2087	488	659	2001	562	560
VORT JET-A 315/2 R	1827	389	572	1661	478	475
VORT JET-A 355/2 R	1984	444	613	1821	514	515
VORT JET-A 400/2 R	2167	488	659	2001	562	560

Dimensions (mm)



ACCESSORIES

MODELS	DESCRIPTION	CODE	PRODUCTS
	<p>SRM - Galvanized steel sheet motorised rectangular dampers for wall installation.</p> <p>The dampers are available in many heights, varying in steps of 200 mm, equal to the height of the individual fin, up to a maximum of 2000 mm. They are also available in various lengths, in the range of 200 mm and 2000 mm in steps of 50 mm.</p>		
		Ø 400	21438 SCM-400
		Ø 450	21439 SCM-450
		Ø 500	21440 SCM-500
		Ø560	21441 SCM-560
		Ø 630	21442 SCM-630
	<p>SCM - Galvanized steel sheet motorised circular dampers for installation on walls and coupled with axial fans.</p>	Ø 710	21443 SCM-710
		Ø 800	21444 SCM-800
		Ø 900	21445 SCM-900
		Ø 1000	21446 SCM-1000
		Ø 1120	21447 SCM-1120
		Ø 1250	21448 SCM-1250
		Ø 1400	21449 SCM-1400