

Standard Ballasts 5–16 W, 230/240/220 V

For compact fluorescent lamps
Shape: 28x41 mm

Vacuum-impregnated with polyester resin

Push-in terminal for leads: 0.5–1 mm²

For the automatic luminaire wiring:

IDC terminals for leads H05V-U 0.5

tw 130

Protection class I

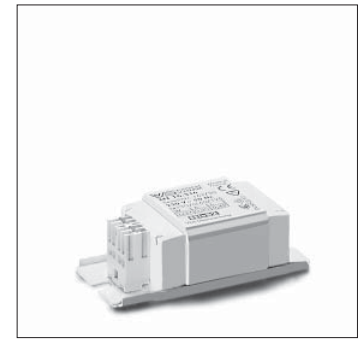
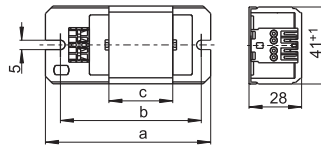

Lamp				Ballast										Capacitor	
Output	Type	Base	Current	Type	Ref. No.	Voltage	a	b	c	Weight	$\Delta t/\Delta t_{on}$	Energy efficiency	C _p	Current	
W			mA			V, Hz	mm	mm	mm	kg	K		μF	mA	
230 V, 50 Hz															
5	TC-S	G23	180	L7/9/11.307*	163694	230, 50	85	75	34	0.32	60/85	B2	2.0	50	
2x5	TC-S	G23	180	LN 13.805*	169647	230, 50	85	75	34	0.32	50/85	B1	2.0	70	
				LN 13.313*	163711	230, 50	85	75	34	0.32	55/80	B2	2.0	70	
7	TC-S	G23	175	L7/9/11.307*	163694	230, 50	85	75	34	0.32	60/85	B2	2.0	50	
2x7	TC-S	G23	160	LNN 13.044	564190	230, 50	155	140	92	0.80	25/40	A2	2.0	80	
				LN 13.805*	169647	230, 50	85	75	34	0.32	50/85	B1	2.0	70	
				LN 13.313*	163711	230, 50	85	75	34	0.32	55/80	B2	2.0	70	
9	TC-S	G23	170	LNN 9/11.015	562658	230, 50	155	140	92	0.80	15/40	A2	2.0	60	
				L7/9/11.307*	163694	230, 50	85	75	34	0.32	60/85	B1	2.0	60	
2x9	TC-S	G23	140	LNN 13.044	564190	230, 50	155	140	92	0.80	25/40	A2	2.0	80	
				LN 13.805*	169647	230, 50	85	75	34	0.32	50/85	B1	2.0	70	
				LN 13.313*	163711	230, 50	85	75	34	0.32	55/80	B2	2.0	80	
10	TC-D	G24d-1	190	LN 13.805*	169647	230, 50	85	75	34	0.32	50/85	B1	2.0	70	
				LN 13.313*	163711	230, 50	85	75	34	0.32	55/80	B2	2.0	70	
	TC-DD	GR10q	180	LN 13.805*	169647	230, 50	85	75	34	0.32	50/85	B1	2.0	70	
				LN 13.313*	163711	230, 50	85	75	34	0.32	55/80	B2	2.0	70	
11	TC-S	G23	155	LNN 9/11.015	562658	230, 50	155	140	92	0.80	15/40	A2	2.0	60	
				L7/9/11.307*	163694	230, 50	85	75	34	0.32	60/85	B1	2.0	80	
13	TC-D/TC-T	G24d-1/GX24d-1	175	LNN 13.044	564190	230, 50	155	140	92	0.80	25/40	A2	2.0	80	
				LN 13.805*	169647	230, 50	85	75	34	0.32	50/85	B1	2.0	80	
				LN 13.313*	163711	230, 50	85	75	34	0.32	55/80	B2	2.0	80	
16	TC-DD	GR8/GR10q	195	LN 16.316*	163730	230, 50	85	75	34	0.32	60/125	B1	2.0	100	
240 V, 50 Hz															
5	TC-S	G23	180	L7/9/11.411	164335	240, 50	85	75	34	0.32	60/85	B2	2.0	50	
2x5	TC-S	G23	180	LN 13.413	164342	240, 50	85	75	34	0.32	60/90	B2	2.0	70	
7	TC-S	G23	175	L7/9/11.411	164335	240, 50	85	75	34	0.32	60/85	B2	2.0	50	
2x7	TC-S	G23	160	LN 13.413	164342	240, 50	85	75	34	0.32	60/90	B2	2.0	70	
9	TC-S	G23	170	L7/9/11.411	164335	240, 50	85	75	34	0.32	60/85	B1	2.0	60	
2x9	TC-S	G23	140	LN 13.413	164342	240, 50	85	75	34	0.32	60/90	B2	2.0	80	
10	TC-D	G24d-1	190	LN 13.413	164342	240, 50	85	75	34	0.32	60/90	B2	2.0	70	
				TC-DD	GR10q	180	LN 13.413	164342	240, 50	85	75	34	0.32	60/90	B2
11	TC-S	G23	155	L7/9/11.411	164335	240, 50	85	75	34	0.32	60/85	B1	2.0	80	
13	TC-D/TC-T	G24d-1/GX24d-1	175	LN 13.413	164342	240, 50	85	75	34	0.32	60/90	B1	2.0	80	
16	TC-DD	GR8/GR10q	195	LN 16.417	164358	240, 50	85	75	34	0.32	60/130	B1	2.0	100	

* Ballasts without CE marking for replacements or markets outside of the EU

Standard Ballasts 5–16 W, 230/240/220 V

Lamp				Ballast									Capacitor	
Output	Type	Base	Current	Type	Ref. No.	Voltage	a	b	c	Weight	$\Delta t/\Delta t_{on}$	Energy efficiency	C _P	Current
W			mA			V, Hz	mm	mm	mm	kg	K		μF	mA
220 V, 60 Hz														
5	TC-S	G23	180	L7/9/11.207	163305	220, 60	85	75	34	0.32	35/65	—	2.0	70
2x5	TC-S	G23	180	L13.210	520992	220, 60	85	75	34	0.32	45/80	—	2.0	90
7	TC-S	G23	175	L7/9/11.207	163305	220, 60	85	75	34	0.32	35/65	—	2.0	70
2x7	TC-S	G23	160	L13.210	520992	220, 60	85	75	34	0.32	45/80	—	2.0	90
9	TC-S	G23	170	L7/9/11.207	163305	220, 60	85	75	34	0.32	35/65	—	2.0	70
2x9	TC-S	G23	140	L13.210	520992	220, 60	85	75	34	0.32	45/80	—	2.0	90
10	TC-D	G24d-1	190	L13.210	520992	220, 60	85	75	34	0.32	45/80	—	2.0	80
	TC-DD	GR10q	180	L13.210	520992	220, 60	85	75	34	0.32	45/80	—	2.0	80
11	TC-S	G23	155	L7/9/11.207	163305	220, 60	85	75	34	0.32	35/65	—	2.0	80
13	TC-D/TC-T	G24d-1/GX24d-1	165	L13.210	520992	220, 60	85	75	34	0.32	45/80	—	2.0	110

Standard Ballasts 18–58 W 230/240/220 V

For compact fluorescent lamps
Shape: 28x41 mm

Vacuum-impregnated with polyester resin
Push-in terminal for leads: 0.5–1 mm²

For the automatic luminaire wiring:
IDC terminals for leads H05V-U 0.5
tw 130

Protection class I

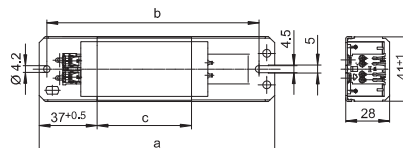

Lamp				Ballast									Capacitor	
Output	Type	Base	Current	Type	Ref. No.	Voltage	a	b	c	Weight	$\Delta t/\Delta t_{on}$	Energy efficiency	C _P	Current
W			mA			V, Hz	mm	mm	mm	kg	K		μF	mA
230 V, 50 Hz														
18	TC-D/TC-T	G24d-2/GX24d-2	220	LN 181.046	564192	230, 50	232.5	220	160	1.35	15/30	A2	2.0	110
				LN 181.940*	508922	230, 50	85	75	34	0.32	50/120	B1	2.0	110
				LN 181.319*	163763	230, 50	85	75	34	0.32	60/140	B1	2.0	110
	TC-F/TC-L	2G10/2G11	370	LN 18.510*	164572	230, 50	155	140	92	0.80	40/65	B1	4.5	120
				LN 18.131*	530941	230, 50	150	140	60	0.55	55/95	B2	4.5	120
				L 18.934*	534621	230, 50	150	140	45	0.43	70/150	—	4.5	120
T-U	2G13	370	LN 18.131*	530941	230, 50	150	140	60	0.55	55/95	B2	4.5	120	
				L 18.934*	534621	230, 50	150	140	45	0.43	70/150	—	4.5	120
2x18	TC-F/TC-L	2G10/2G11	400	LN 2X18.043	564189	230, 50	150	135	60	0.55	40/160	A2	4.0	210
				LN 2x18.135*	532155	230, 50	150	140	45	0.43	65	B1	4.0	210
22	T-R	G10q	400	LN 30.530*	164680	230, 50	155	140	92	0.80	45/65	B2	4.5	200
24	TC-F/TC-L	2G10/2G11	345	LN 24/26.804*	534490	230, 50	150	140	60	0.55	55/110	B2	4.5	150
				L 18.934*	534621	230, 50	150	140	45	0.43	70/150	—	4.5	150

* Ballasts without CE marking for replacements or markets outside of the EU

Standard Ballasts 4–13 W 230/240/220 V

For fluorescent lamps
Shape: 28x41 mm

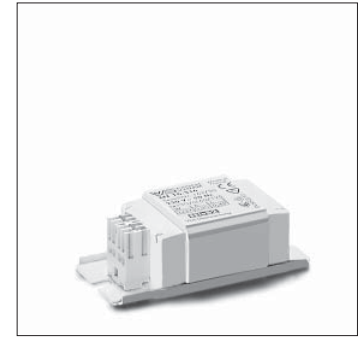
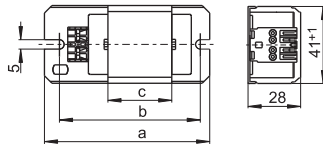

Vacuum-impregnated with polyester resin
Push-in terminal for leads: 0.5–1 mm²
For the automatic luminaire wiring:
IDC terminals for leads H05V-U 0.5
tw 130
Protection class I

Lamp				Ballast										Capacitor	
Output	Type	Base	Current	Type	Ref. No.	Voltage	a	b	c	Weight	Δt/Δtan.	Energy efficiency	Cp	Current	
W			mA			V, Hz	mm	mm	mm	kg	K		μF	mA	
230 V, 50 Hz															
4	T5 (T16)	G5	170	L4/6/8.304*	163683	230, 50	85	75	34	0.32	55/85	B2	2.0	40	
2x4	T5 (T16)	G5	155	L4/6/8.304*	163683	230, 50	85	75	34	0.32	55/85	B1	2.0	50	
6	T5 (T16)	G5	160	L4/6/8.304*	163683	230, 50	85	75	34	0.32	55/85	B1	2.0	50	
2x6	T5 (T16)	G5	175	LN 13.313*	163711	230, 50	85	75	34	0.32	55/80	B1	2.0	65	
8	T5 (T16)	G5	145	L4/6/8.304*	163683	230, 50	85	75	34	0.32	55/85	B1	2.0	60	
2x8	T5 (T16)	G5	155	LN 13.044	564190	230, 50	155	140	92	0.80	25/40	A2	2.0	80	
				LN 13.313*	163711	230, 50	85	75	34	0.32	55/80	B1	2.0	85	
13	T5 (T16)	G5	165	LN 13.044	564190	230, 50	155	140	92	0.80	25/40	A2	2.0	80	
				LN 13.313*	163711	230, 50	85	75	34	0.32	55/80	B1	2.0	80	
240 V, 50 Hz															
4	T5 (T16)	G5	170	L4/6/8.404	164326	240, 50	85	75	34	0.32	55/80	B2	2.0	40	
2x4	T5 (T16)	G5	155	L4/6/8.404	164326	240, 50	85	75	34	0.32	55/80	B1	2.0	50	
6	T5 (T16)	G5	160	L4/6/8.404	164326	240, 50	85	75	34	0.32	55/80	B1	2.0	50	
2x6	T5 (T16)	G5	175	LN 13.413	164342	240, 50	85	75	34	0.32	60/90	B1	2.0	65	
8	T5 (T16)	G5	145	L4/6/8.404	164326	240, 50	85	75	34	0.32	55/80	B1	2.0	60	
2x8	T5 (T16)	G5	155	LN 13.413	164342	240, 50	85	75	34	0.32	60/90	B1	2.0	85	
13	T5 (T16)	G5	165	LN 13.413	164342	240, 50	85	75	34	0.32	60/90	B1	2.0	80	
220 V, 60 Hz															
4	T5 (T16)	G5	170	L4/6/8.218	532644	220, 60	85	75	34	0.32	60/80	—	2.0	40	
2x4	T5 (T16)	G5	155	L4/6/8.218	532644	220, 60	85	75	34	0.32	60/80	—	2.0	50	
6	T5 (T16)	G5	160	L4/6/8.218	532644	220, 60	85	75	34	0.32	60/80	—	2.0	50	
2x6	T5 (T16)	G5	175	L13.210	520992	220, 60	85	75	34	0.32	45/80	—	2.0	65	
8	T5 (T16)	G5	145	L4/6/8.218	532644	220, 60	85	75	34	0.32	60/80	—	2.0	60	
2x8	T5 (T16)	G5	155	L13.210	520992	220, 60	85	75	34	0.32	45/80	—	2.0	85	
13	T5 (T16)	G5	165	L13.210	520992	220, 60	85	75	34	0.32	45/80	—	2.0	80	

* Ballasts without CE marking for replacements or markets outside of the EU

Standard Ballasts 14–65 W, 230 V

For fluorescent lamps
Shape: 28x41 mm

Vacuum-impregnated with polyester resin

Push-in terminal for leads: 0.5–1 mm²

For the automatic luminaire wiring:

IDC terminals for leads H05V-U 0.5

tw 130

Protection class I

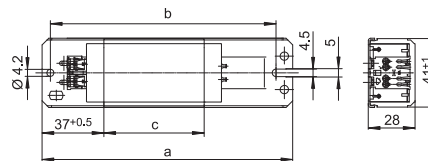
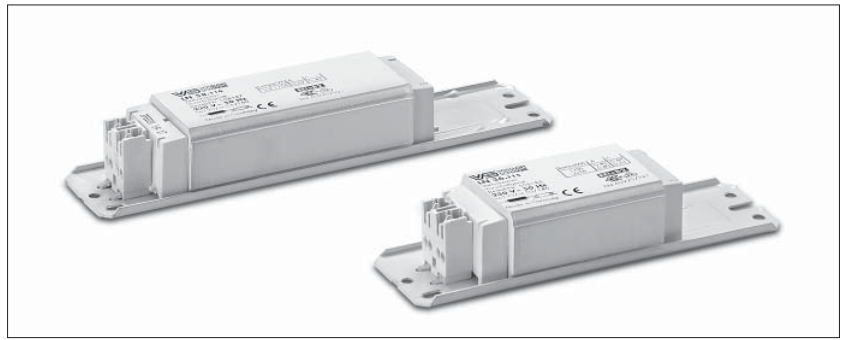

Lamp				Ballast									Capacitor	
Output	Type	Base	Current	Type	Ref. No.	Voltage	a	b	c	Weight	Δt/Δtan.	Energy efficiency	C _p	Current
W			mA			V, Hz	mm	mm	mm	kg	K		μF	mA
230 V, 50 Hz														
14	T8 (T26)	G13	395	LN 18.510*	164572	230, 50	155	140	92	0.80	40/65	B2	4.5	150
15	T8 (T26)	G13	310	LN 15.329*	163861	230, 50	150	140	60	0.55	50/80	B2	3.5	120
2x15	T8 (T26)	G13	340	INN 30.045	564191	230, 50	232.5	220	160	1.35	25/40	A2	4.0	185
				LN 30.801*	169645	230, 50	150	140	60	0.55	55/110	B2	4.0	185
				L 30.347*	164033	230, 50	150	140	60	0.55	60/150	—	4.0	185
16	T8 (T26)	G13	200	LN 16.316*	163730	230, 50	85	75	34	0.32	60/125	B1	2.0	90
18/20	T8 (T26)/T12 (T38)	G13	370	LN 18.510*	164572	230, 50	155	140	92	0.80	40/65	B1	4.5	120
				LN 18.131*	530941	230, 50	150	140	60	0.55	55/95	B2	4.5	120
				L 18.934*	534621	230, 50	150	140	45	0.43	70/150	—	4.5	120
2x18/20	T8 (T26)/T12 (T38)	G13	400	INN 2x18.043	564189	230, 50	150	135	60	0.55	40/160	A2	4.0	210
				LN 2x18.135*	532155	230, 50	150	140	45	0.43	65	B1	4.0	210
25	T12 (T38)	G13	290	L 25.346*	164013	230, 50	150	140	60	0.55	45/80	B1	3.5	130
30	T8 (T26)	G13	365	INN 30.045	564191	230, 50	232.5	220	160	1.35	25/40	A2	4.5	180
				LN 30.801*	169645	230, 50	150	140	60	0.55	55/110	B2	4.5	180
36-1	T8 (T26)	G13	556	L 36.342*	538072	230, 50	195	180	110	0.87	50/120	B2	6.5	250
36/40	T8 (T26)/T12 (T38)	G13	430	LN 36.570*	169779	230, 50	155	140	92	0.80	35/90	B1	4.5	210
				LN 36.511*	164590	230, 50	155	140	92	0.80	35/95	B1	4.5	210
				LN 36.130*	527191	230, 50	150	140	60	0.55	50/140	B2	4.5	210
				LN 36.149*	529029	230, 50	150	140	60	0.55	55/150	B2	4.5	210
38	T8 (T26)	G13	430	L 36.132*	535977	230, 50	150	140	45	0.43	65	—	4.5	210
				LN 36.570*	169779	230, 50	155	140	92	0.80	35/90	B1	4.5	210
				LN 36.511*	164590	230, 50	155	140	92	0.80	35/95	B1	4.5	210
				LN 36.149*	529029	230, 50	150	140	60	0.55	55/150	B2	4.5	210
58/65	T8 (T26)/T12 (T38)	G13	670	L 36.132*	535977	230, 50	150	140	45	0.43	65	—	4.5	210
				LN 58.568*	169389	230, 50	233	220	160	1.31	35/95	B1	7.0	320
				LN 58.990*	509349	230, 50	190	180	110	0.95	50/130	B2	7.0	320
				LN 58.116*	508186	230, 50	190	180	92	0.80	55/160	B2	7.0	320
				L 58.718*	169658	230, 50	190	180	92	0.80	60/170	—	7.0	320

* Ballasts without CE marking for replacements or markets outside of the EU