

Standard Ballasts for HS and HI Lamps 35 to 70 W

Shape: 53x66 mm

For high pressure sodium lamps (HS),
metal halide lamps (HI) and
ceramic discharge lamps (C-HI)
Vacuum-impregnated with polyester resin
Screw terminals: 0.5–2.5 mm²
Protection class I
tw 130
Ballasts for pulse ignition system on request

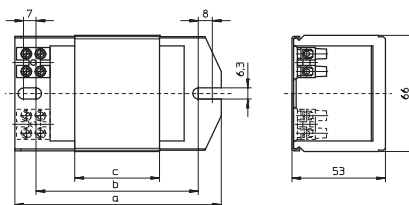
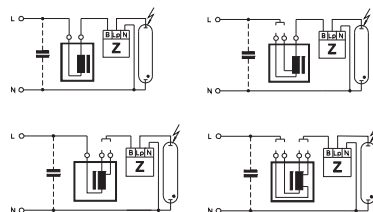

Lamp			Ballast										Capacitor	
Output W	Type	Current A	Type	Ref. No.	Voltage AC V, Hz	a mm	b mm	c mm	Weight kg	Δt K	Power factor λ	Energy efficiency	C _p μF	I _N A
35	HS, HI	0.53	NaHJ 35.485*	526517	220/230, 50	108	86	36	1.07	60	0.40	EEI=A3	6	0.22/0.21
			NaHJ 35.485*	161367	230/240, 50	108	86	36	1.07	60	0.40	EEI=A3	6	0.22/0.21
			NaHJ 35.638	161371	220, 60	108	86	36	1.07	50	0.41	EEI=A3	5	0.23
50	HS, HI	0.76	NaH 50.486*	161379	230/240, 50	108	86	36	1.07	65	0.37	EEI=A3	8	0.30/0.29
			NaH 50.654	161399	220, 60	108	86	36	1.07	60	0.36	EEI=A3	8	0.31
50	HS, HI	0.76	NaHJ 70/50.157*	160613	230, 50	108	86	42	1.23	55	0.37	EEI=A3	8	0.30
70	HS, HI	0.98									70	0.37	EEI=A3	12
70	HS, HI	0.98	NaHJ 70.300	174961	220, 50	108	86	36	1.07	75	0.40	EEI=A3	12	0.40
			NaHJ 70.128*	533568	230, 50	108	86	36	1.07	70	0.36	EEI=A3	12	0.38
			NaHJ 70.128*	539434	230/240, 50	108	86	36	1.07	70/75	0.36	EEI=A3	12	0.38/0.37
			NaHJ 70.158	161662	240, 50	108	86	42	1.23	70	0.36	EEI=A3	12	0.37
			NaHJ 70.128	538407	240, 50	108	86	36	1.07	75	0.37	EEI=A3	12	0.37
			NaHJ 70.653	161392	220, 60	108	86	36	1.07	60	0.42	EEI=A3	10	0.40

* Ballasts without CE marking for replacements or markets outside of the EU

Standard Ballasts for HS and HI Lamps 70 to 250 W

Shape: 53x66 mm

Lamp			Ballast										Capacitor	
Output W	Type	Current A	Type	Ref. No.	Voltage AC V, Hz	a mm	b mm	c mm	Weight kg	Δt K	Power factor λ	Energy efficiency	Cp μF	IN A
70	HS, HI	0.98	NaHj 100/70.703*	161469	230, 50	145	120	48	1.39	60	0.37	EEI=A3	12	0.38
100	HS, HI	1.20								70	0.43	EEI=A3	12	0.55
70	HS, HI	0.98	NaHj 100/70.519	161158	230/240, 50	145	120	75	2.03	50	0.36	A2	12	0.38/0.37
100	HS, HI	1.20								60	0.42	EEI=A3	12	0.55/0.53
70	HS, HI	0.98	NaHj 100/70.709	161471	220, 60	145	120	48	1.39	50	0.39	EEI=A3	10	0.40
100	HS, HI	1.20								60	0.44	EEI=A3	10	0.57
100	HS, HI	1.20	NaHj 100.126	507671	220, 50	108	86	42	1.24	75	0.44	EEI=A3	12	0.55
			NaHj 100.941*	161707	230/240, 50	108	86	42	1.24	75/80	0.42	EEI=A3	12	0.55/0.53
			NaHj 100.271	530195	220, 60	108	86	42	1.24	75	0.45	EEI=A3	10	0.57
150	HS, HI	1.80	NaHj 150.159	533602	220, 50	145	120	64	1.80	75	0.41	EEI=A3	20	0.80
			NaHj 150.620*	533565	230, 50	145	120	64	1.80	70	0.40	EEI=A3	20	0.77
			NaHj 150.620	534540	240, 50	145	120	64	1.80	75	0.40	EEI=A3	20	0.74
			NaHj 150.679	526196	220, 60	145	120	55	1.55	75	0.44	EEI=A3	16	0.80
			NaHj 150.679	537793	220, 60	117	92	55	1.55	75	0.44	EEI=A3	16	0.80
250	HS, HI	3.00	NaHj 250.204	529087	220, 50	160	135	95	2.50	80	0.42	EEI=A3	32	1.32
			NaHj 250.160	160597	220, 50	180	155	110	2.84	75	0.41	EEI=A3	32	1.32
			NaHj 250.915*	161686	230, 50	180	155	110	2.84	80	0.40	EEI=A3	32	1.26
			NaHj 250.340*	504109	230/240, 50	180	155	110	2.84	80	0.39	EEI=A3	32	1.26/1.21
			NaHj 250.340	178177	240, 50	180	155	110	2.84	80	0.39	EEI=A3	32	1.21
			NaHj 250.163	529072	220, 60	160	135	95	2.50	70	0.42	A2	25	1.35
			NaHj 250.163	160604	220, 60	180	155	95	2.50	70	0.42	A2	25	1.35

* Ballasts without CE marking for replacements or markets outside of the EU

1

2

3

4

5

6

7

8

9

10